

DVP510A Quick Start Guide

DUKANE

www.dukaneav.com

⚠ Important

* Please activate your warranty at www.dukaneav.com

* Please visit our website www.dukaneav.com to download latest version of Software, Multilingual User Manual and Quick Start Guide.

1. Package Contents

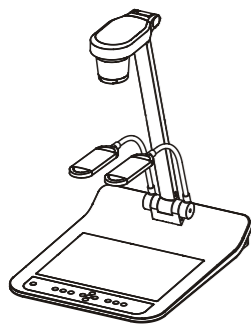

Important information sheet indicating User Manual and other support materials are located on the Dukane website for this product.

Mini DIN Adapter



AC Adapter

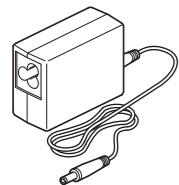

VGA Cable

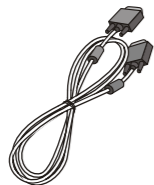

USB Cable

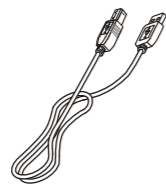

Audio Cable

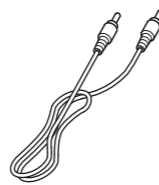

Power Cord

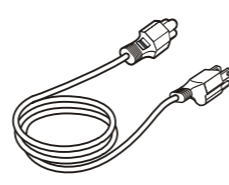

* Appearance may vary in different countries

Remote Control



Remote Control Holder

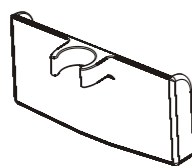

Microscope Adapter

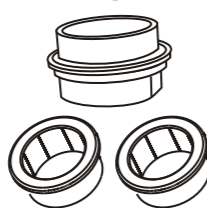

⚠ The package contents are subject to change without notice.

2. Getting Started

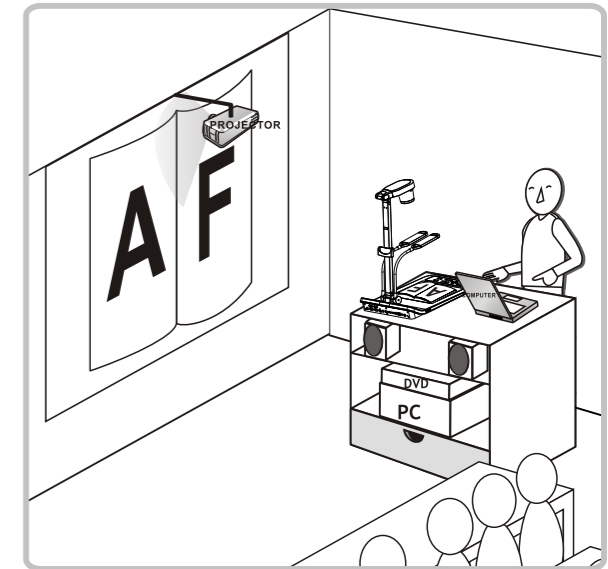
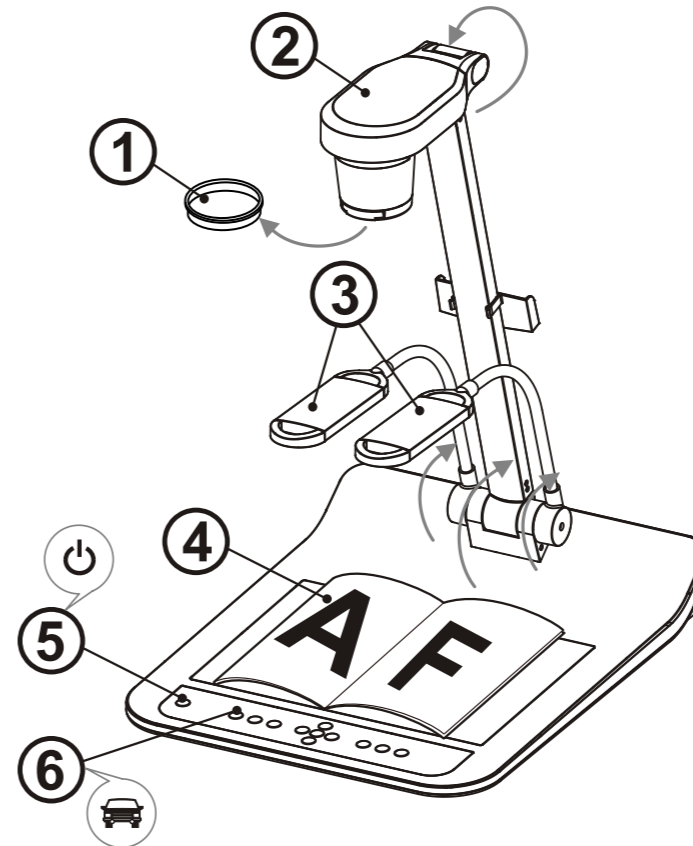

- ① Remove the lens cap.
- ② Pull up the camera and the camera arm. The camera should aim at the center of the presenter.
- ③ Pull up the lamp arm and adjust it to appropriate position.
- ④ Place an object to be displayed under the camera.
- ⑤ Turn the power on.
- ⑥ Press the [AUTO TUNE] button to optimize the image. You are ready to teach / present.

* You can adjust the camera slightly to point at the center of the document when the camera arm is fully extended.

3. Installation & Connection

▼ Connect to a Projector or Monitor

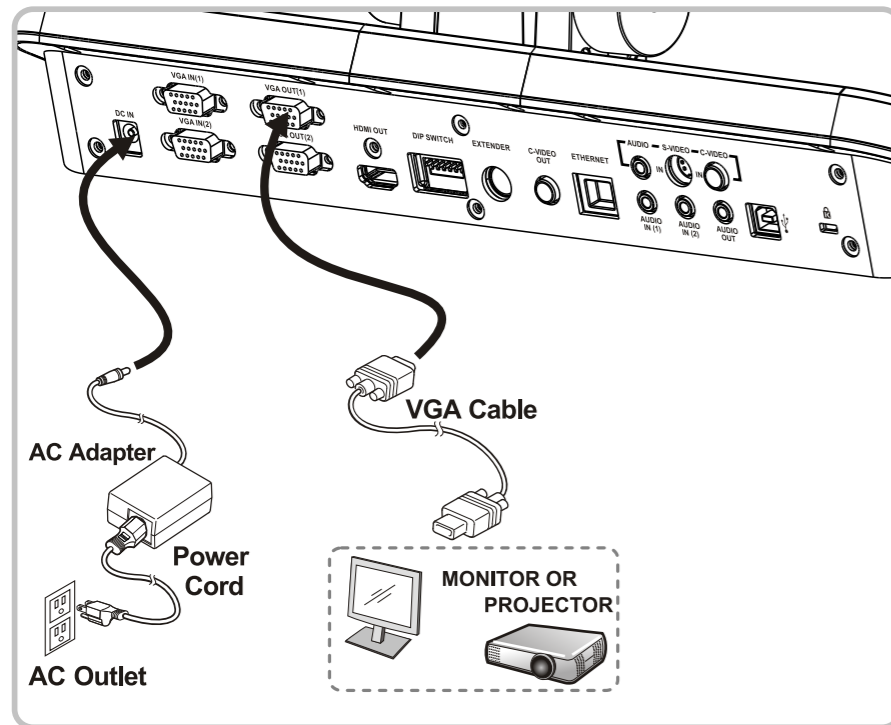

▼ Connect to a Computer and Use Dukane Software or Connect to an Interactive Whiteboard (IWB).

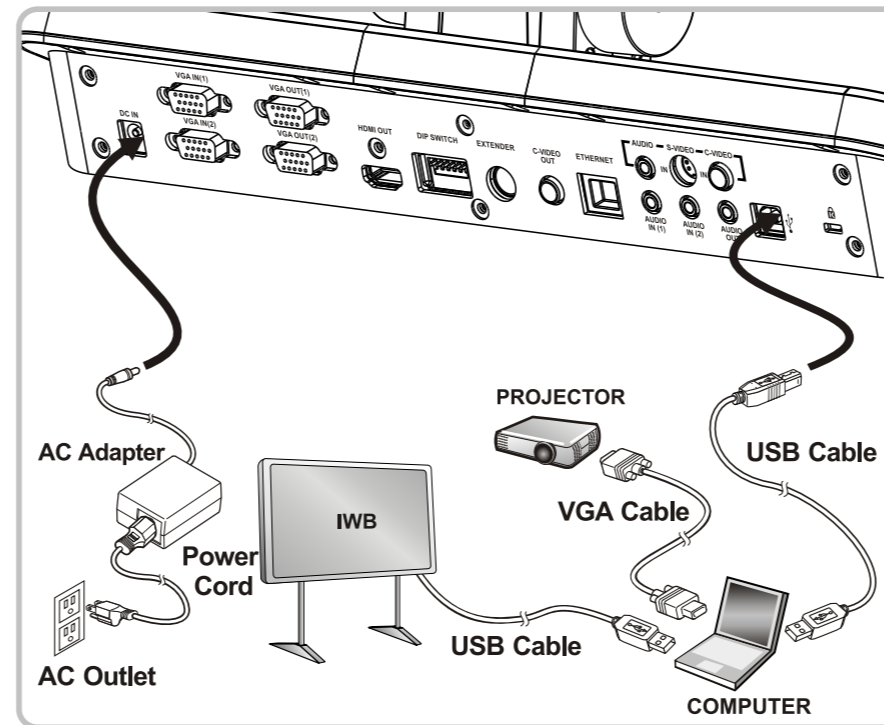

▼ Connect to the Network

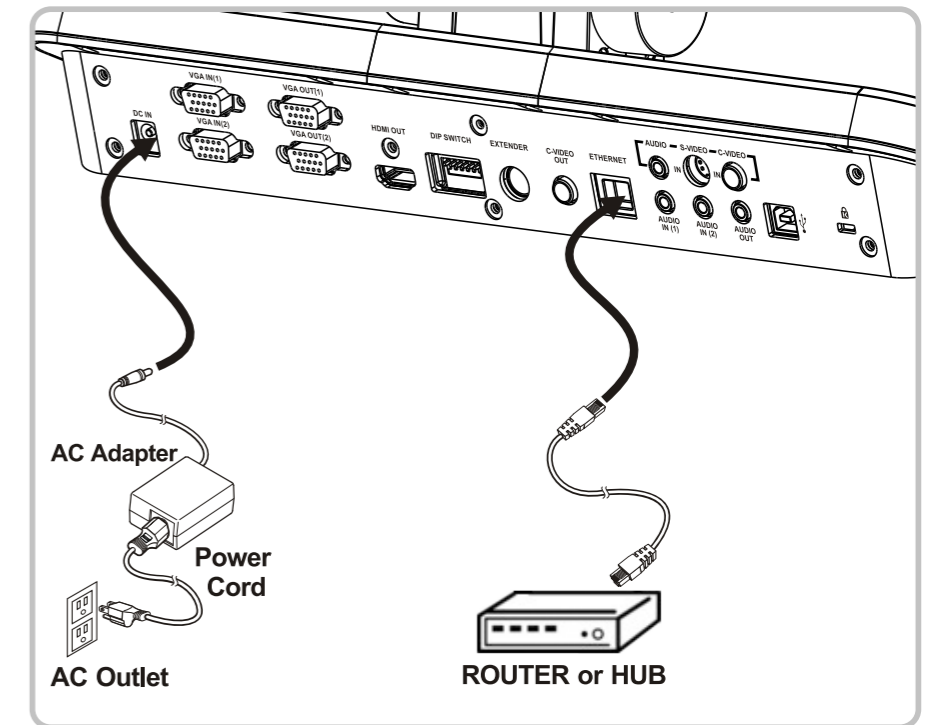

* Driver and software can be downloaded from Dukane website.

▼ Connect to a TV (via C-Video or S-Video)

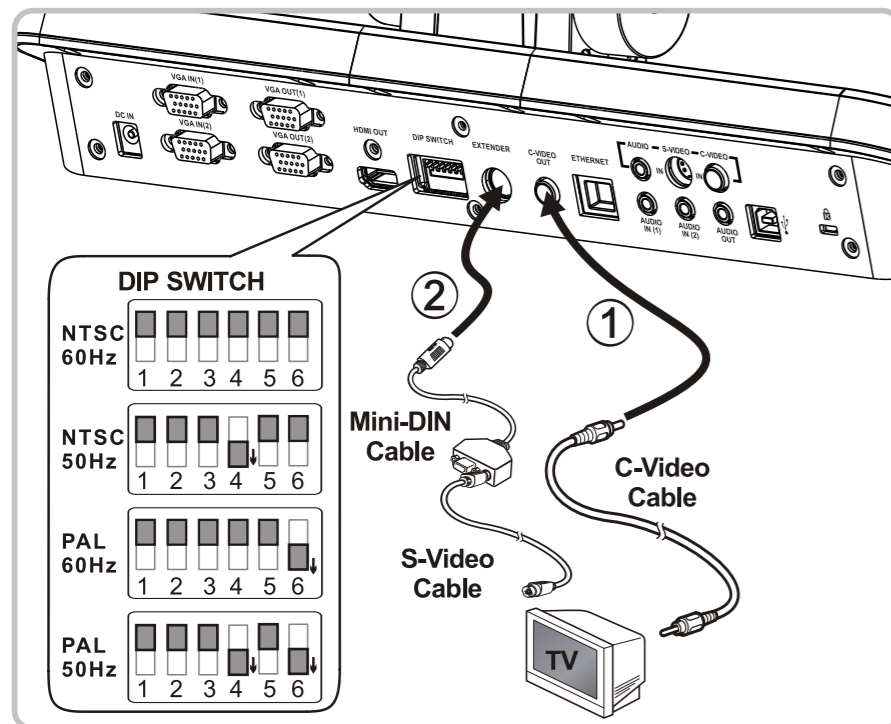

▼ Connect to an HDTV

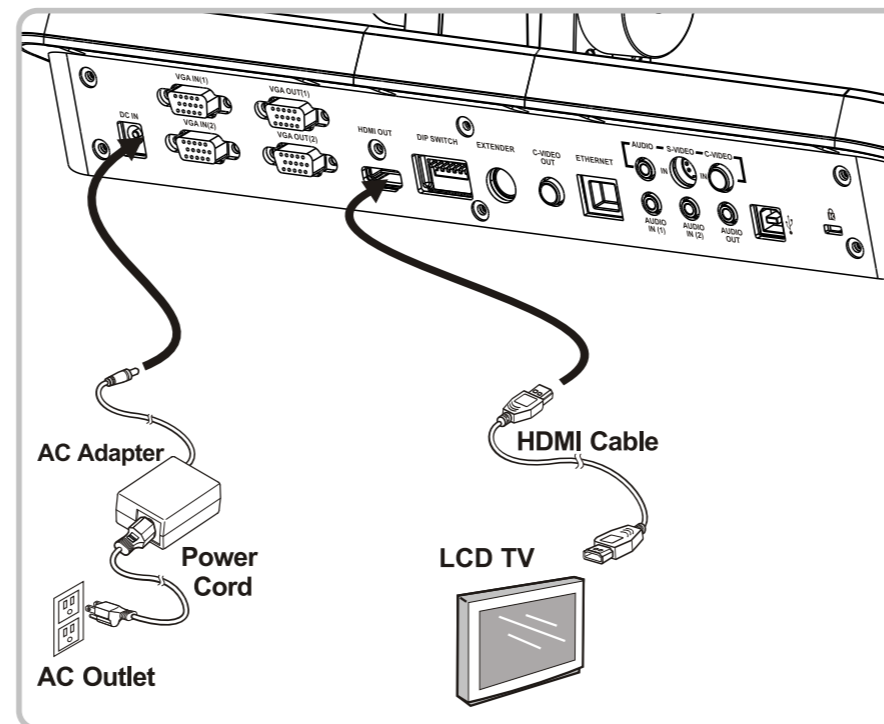

▼ Connect to DVD (via C-Video or S-Video)

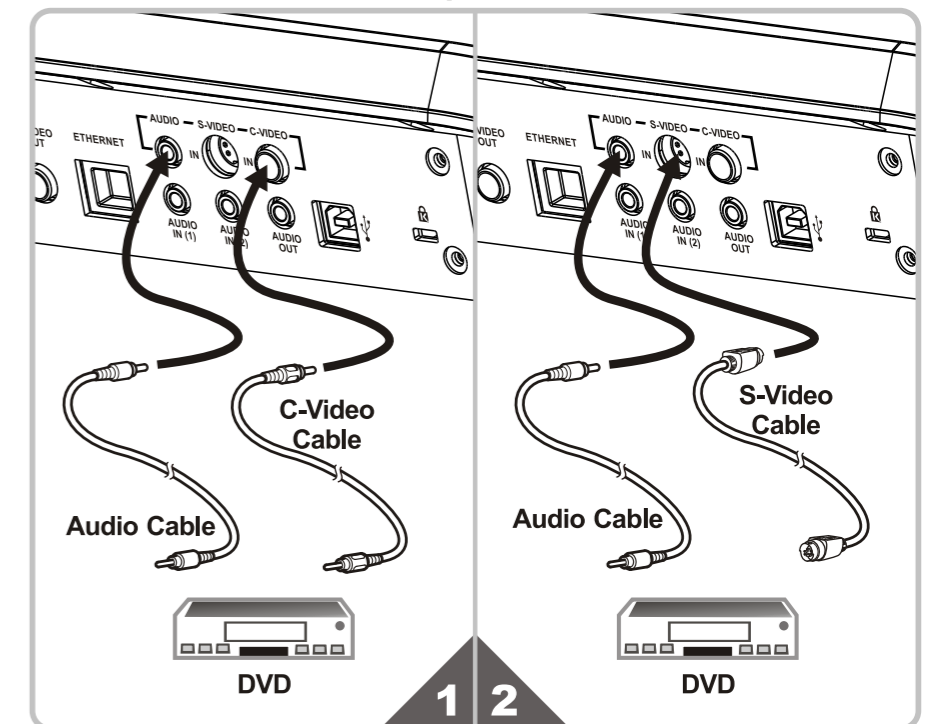

* NTSC: USA, CANADA, MEXICO, PANAMA, CHILE, JAPAN, TAIWAN, KOREA AND PHILIPPINES.

* PAL: Country / region not listed above.

* To make DIP switch set up effectiveness, please re-plug the power cord and reboot the machine.